



Winterwarm XR+ series

Winterwarm presents the XR+ -series: a non-condensing gas-fired unit air heater incorporating a modern design with compact measurements, which looks great in any environment.



Winterwarm
heating solutions 

Characteristics Winterwarm XR+ series:

- Very compact
- Variable air distribution
- Airlift effect
- Modulating premix burner and fan
- SS-heat exchanger as standard
- Energy saving
- Simple to install
- Modern design



The XR+ range is the successor of the standard XR range, the popular gas fired unit air heater from Winterwarm with its unique patented heat exchanger. The compact heaters have proven to be a cost-effective heating solution for almost every type of industrial or commercial building. The improved XR+ heaters fully comply with the ErP2021 regulations but have no need for a condensate drain. The heaters are very suitable for large and small rooms, like production buildings, warehouses, garages, retail buildings. For the heating of shops, showrooms, cafeterias, etc, we recommend selecting the HR-EC series because of the lower sound level.

Heat on the right spot

One of the unique characteristics of the XR+ is that the heater can be suspended in any desirable position;

horizontal, vertical or at any angle in between, therefore easily directing the airflow in the direction required. When blowing out vertically, the heater also functions as a de-stratification fan.

Modulating burner and fan

The burner and the fan are both modulating (down to approx. 60%): the room is brought up to temperature at full output and subsequently kept at the desired temperature on reduced output. The energy consumption and the noise level are reduced to a minimum while the comfort level increases as there are fewer fluctuations in the room temperature. As the heat exchanger is turned upside down a more even temperature of the discharged air is realised (airlift effect).

Delta T-control

The XR+ series uses an advanced control system which increases the comfort even further. Two temperature sensors, one within the heater and one in the room, measure continuously the temperature gradient. Should the temperature gradient increase beyond the set value, the unit will switch on the fan and circulate the warm air. The gradient control in combination with the modulating burner and fan can achieve energy savings up to 15% in comparison with conventional unit air heaters.

Of course the XR is also provided with a summer ventilation possibility for continuous air circulation.

Suspension

Both XR+ models (10-30 and 40-60) have various suspension possibilities:

- Bracket for horizontal or vertical air distribution, consisting of 3 U-sections, 2 of which are mounted to the heater and 1 to the wall or to the ceiling. Also available are clamps for mounting the bracket to a steel "H"-section.

XR10+ - XR30+

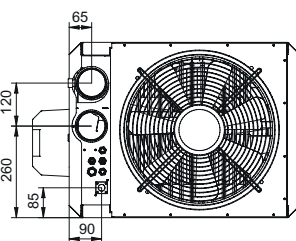
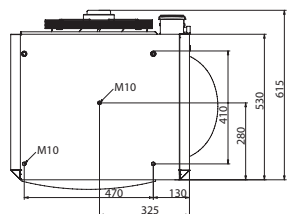
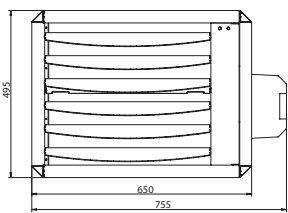

XR40+ - XR60+

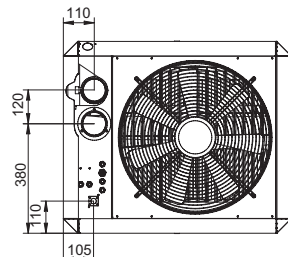
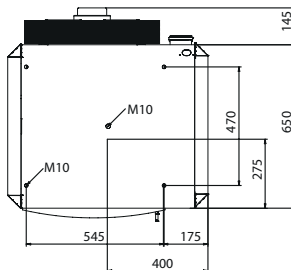
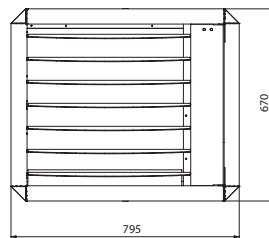

Clamps for H-section



Airlift effect



- Design bracket, this bracket can rotate in both the horizontal and vertical direction, consequently, the heater can blow in any desired direction. Suitable for mounting on a wall or ceiling (types XR10+/XR30+).
- All XR+ heaters have 4 recessed suspension points in the corner for M10 threaded bar. This allows the heaters to be suspended in the conventional manner.
- Vertical suspension kit (80-165cm) to attach to an "H"-section (horizontal and vertical air discharge possible).

Controls

Especially for the XR+ series Winterwarm has developed the MultiTherm thermostat. This ther-

mostat optimizes the gradient control, the modulating burner and fan speed. Both of these features together realize optimal energy consumption. For the user, the operation of the thermostat is simple. The user can access various information and make any necessary adjustments using the on-screen prompts, or detect any recent failures. The MultiTherm is available in 2 models: **Standard** and **Comfort** (with various programming possibilities) and can control up to 8 heaters. For the MultiTherm C a remote sensor is available to control the heater from a distance.



MultiTherm S
(art.no. IX3911)



MultiTherm C
(art.no. IX3912)



Remote sensor
(art.no. GA3929)

Features:	MultiTherm S	MultiTherm C
7 day program		x
10 different on/off programs		x
Manual override		x
Automatic adjustment for daylight saving time		x
Modulates the heater according to the room temperature	x	x
Summer ventilation	x	x
Compensation wall influence	x	x
Keyboard locking		x
Frost protection	x	x
Failure diagnosis and reset for each unit air heater	x	x
Wired in twisted pair screened cable	x	x
Controls 1-8 heaters	x	x
Temperature range 0 - 30°C	x	x
Optional remote sensor (GA3929)	x	x
Optional external control (for external on/of signal)	x	x

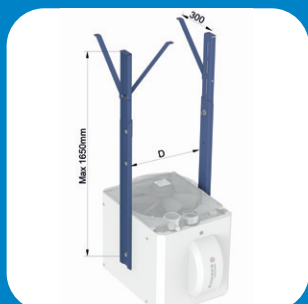
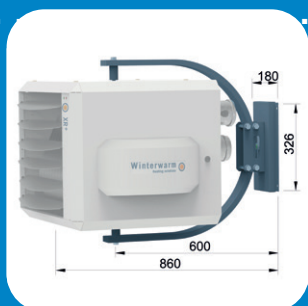

	A	B	C	D
XR10+/30+	550	640	830	540
XR40+/60+	665	815	990	720

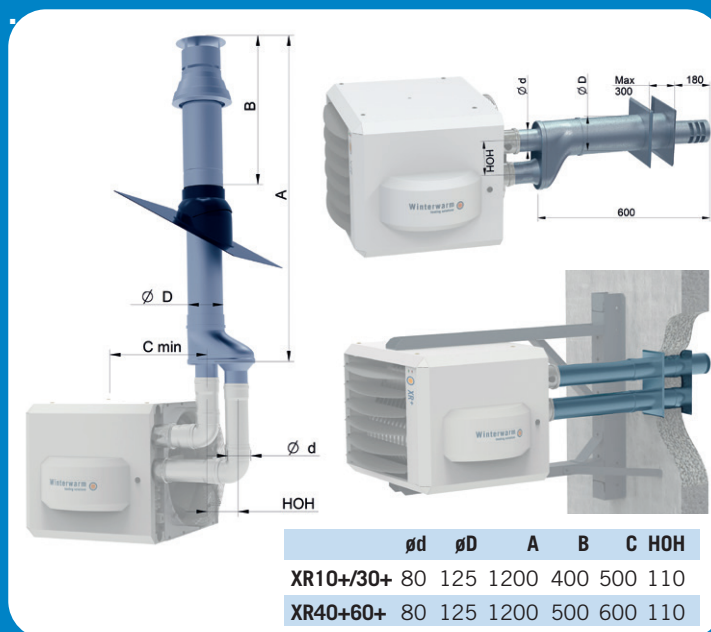

Technical data XR+ series

Type	Unit	XR 10+	XR 20+	XR 30+	XR 40+	XR 50+	XR 60+
Nominal heat input max. (h.i.)	kW	14.0	22.8	32.0	44.0	55.0	66.0
Nominal heat input min. (h.i.)	kW	8.5	13.5	18.0	26.4	33.0	39.6
Maximum efficiency	%	93.8	94.6	94.6	95.8	95.6	95.6
Maximum heat output	kW	12.7	20.5	28.8	41.1	50.7	61.2
Minimum heat output	kW	8.0	12.8	17.0	25.3	31.5	37.9
Air output (warm)	m ³ /h	2,950	4,000	4,200	6,000	8,500	8,500
Throw horizontal	m	22	30	31	32	46	46
Throw vertical (warm)	m	5	7	7	8	11	11
Voltage (50Hz)	V	230	230	230	230	230	230
Electrical power	W	200	300	300	325	750	750
Electrical current	A	0.9	1.4	1.4	1.5	3.5	3.5
Sound level (@ 5 meter)	dB(A)	56.5	58.0	57.5	59.0	64.0	64.0
Weight	kg	46	50	53	78	86	90
Gas consumption natural gas (G20)	m ³ /h	1.5	2.4	3.4	4.7	5.8	7.0
Gas consumption propane (G31)	kg/h	1.1	1.8	2.5	3.5	4.4	5.3
Gas connection	G"	1/2	1/2	1/2	3/4	3/4	3/4
Min. suspension height horizontal throw	m	1.7	1.7	1.7	2.7	2.7	2.7
Min. suspension height vertical throw	m	4	4	4	5	6	6
Max. length flue, horizontal throw*	m	6	6	6	8	8	8
Max. length flue, vertical throw*	m	2	2	2	2	2	2

*) for each 90° elbow, 1.5m. less; for each 45° elbow, 1 m. less. Condensation exhaust necessary when flue > 4m

Winterwarm: leading

Winterwarm has been engaged in the development, production and sales of industrial heating in Europe since 1936.

The company not only specialises in indirect fired unit air heaters, but also sells water heaters, electric heaters, destratification fans and gas and oil-fired heaters for the agricultural and horticultural industry.



Winterwarm
heating solutions 

Winterwarm BV

Industrieweg 8 Winterswijk The Netherlands
P.O.Box 36 NL-7100 AA Winterswijk The Netherlands
Tel. +31 (0)543 54 63 00
www.winterwarm.com info@winterwarm.nl

Winterwarm UK Ltd.

Unit H3, Taylor Business Park, Warrington Road,
Risley, Warrington, Cheshire WA3 6BL
Tel.+44 (0)192 57 65 799
www.winterwarmuk.com enquiries@winterwarmuk.com

Renowned Winterwarm quality

- More than 85 years of experience
- ISO 9001-2015 certified
- Quick delivery
- Reliable

